



17 Portway, Old Sarum, Salisbury, Wiltshire, SP4 6BY

£1,400 PCM



## About The Property

This is a well-appointed three-bedroom semi-detached house located on the north side of the city, near Old Sarum. The property features a spacious entrance hall and a downstairs cloakroom. The fully fitted kitchen/breakfast room includes a high-quality range of units, featuring a gas hob, a single electric oven, an integral fridge and freezer, as well as an integral dishwasher and washing machine. French doors lead out to the garden.

The full-length sitting room also has doors that open to the garden. Additionally, there is a study. On the first floor, you will find three good-sized bedrooms, two of which are doubles. The master bedroom includes an en-suite shower room and offers space for wardrobes. The family bathroom is equipped with a low-level shower attachment over the bath.

Outside, there is an enclosed rear garden with grass and some shrubs, along with a pedestrian gate leading to the parking area. The property also includes a single garage located within the coach house opposite the rear.

The house is unfurnished and is heated via gas central heating.

- Three bedrooms
- En suite shower room
- Fitted kitchen/breakfast room
- Popular location
- Long term let
- Unfurnished
- Gas fired central heating
- Single bay garage

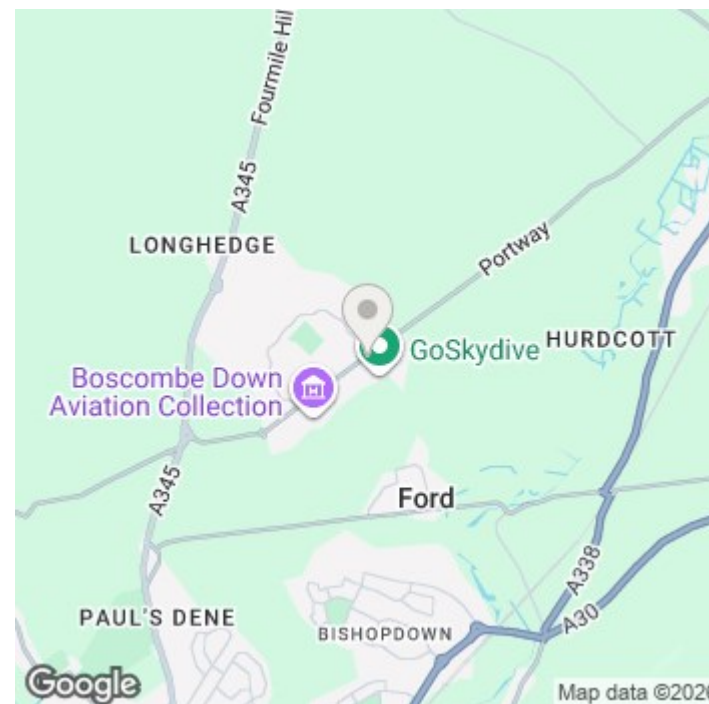



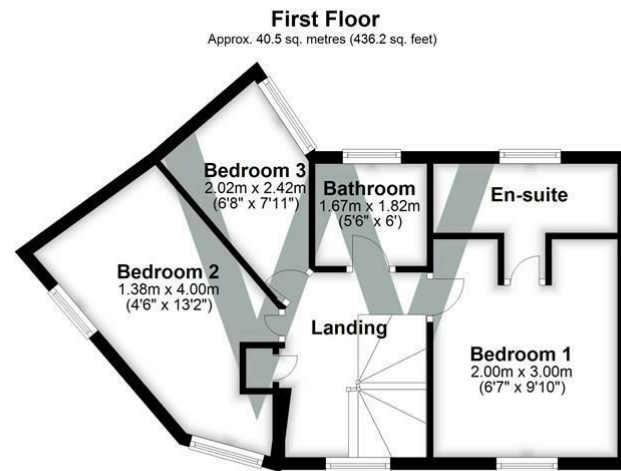
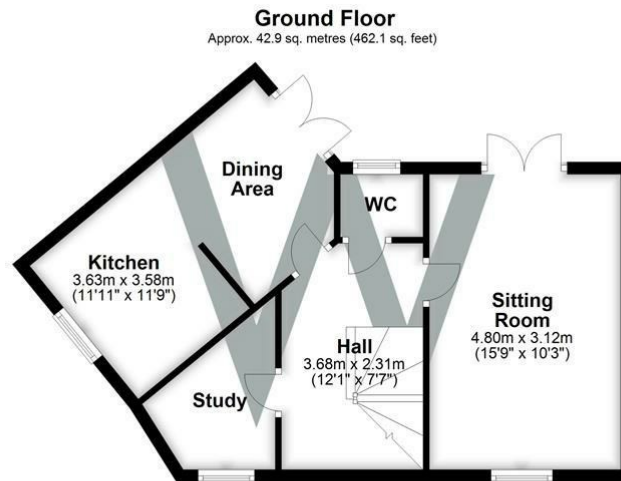

Total area: approx. 83.5 sq. metres (898.3 sq. feet)

## Further Information

Let available date: 16th March 2026  
NB: This date is provisional and will only be confirmed once referencing has been successfully completed.

Property type: House - Semi-Detached

Furnish type: Unfurnished

Deposit: £1,615

Local authority: Wiltshire Council

Council Tax: Band D

EPC: C(78)

### Energy Efficiency Rating

	Current	Potential
Very energy efficient - lower running costs		
(92 plus) <b>A</b>		<b>91</b>
(81-91) <b>B</b>		
(69-80) <b>C</b>	<b>78</b>	
(55-68) <b>D</b>		
(39-54) <b>E</b>		
(21-38) <b>F</b>		
(1-20) <b>G</b>		
Not energy efficient - higher running costs		
<b>England &amp; Wales</b>		EU Directive 2002/91/EC